

CITY OF YUBA CITY
STAFF REPORT

Date: August 20, 2019
To: Honorable Mayor & Members of the City Council
From: Public Works Department
Presentation by: Benjamin Moody, Interim Assistant Public Works Director

Summary

Subject: Levying Assessments for Yuba City Lighting and Landscape Maintenance District Nos. 2, 3, 4 & 5 (Town Center and 69 subdivisions throughout Yuba City), and Yuba City Lighting and Landscape Maintenance District No. 6 (Commercial District)

Recommendation: A. Conduct a Public Hearing and after consideration
B. Adopt a Resolution confirming and ordering the annual levy of assessments for fiscal year 19-20 for the Yuba City Lighting and Landscape Maintenance District Nos. 2, 3, 4, 5, & 6 (Town Center, 69 subdivisions throughout Yuba City including the Palisades Subdivisions and Butte Vista neighborhood, and commercial district)

Fiscal Impact: District 2 – increase in assessment
District 3 – increase in assessment
District 4 – increase in assessment
District 5 – increase in assessment
District 6 – increase in assessment

Purpose:

To continue to provide Lighting and Landscape Maintenance throughout the City pursuant to the provisions of the Landscaping and Lighting Act of 1972 and Article XIIIID of the California Constitution.

Background:

The City annually levies and collects special assessments in order to maintain and service landscaping and lighting improvements that provide special benefit to the parcels identified in Lighting and Landscape Maintenance Districts 2-6. The assessments were approved by the property owners of record through a protest ballot proceeding at the time the Districts were formed.

District 2 (Town Square Area), 3, 4, 5, (69 subdivisions located throughout the City) and 6 (several commercial areas throughout the City) have provisions for a cost of living adjustment (COLA), which is based on the Consumer Price Index from January to January. The COLA was determined to be a 1.55% change from last year.

On July 16, 2019, Council adopted resolutions directing the filing of the Annual Reports and resolutions of intention to order the improvements, and setting a public hearing for August 20, 2019 to establish the assessments for Fiscal Year 19/20.

Analysis:

District Nos. 2 and 5 experienced a higher cost of maintenance in Fiscal Year 18/19 due to a heightened number of requests to perform tree maintenance within the Districts. These requests outpaced the COLA provisions, which caused the expenditures to exceed the revenues within the Districts.

District Nos. 2, 3, 4, 5 and 6 will see increases in their annual levies. The levies were raised in response to inflation and a renewed focus by the City to improve maintenance in the maintained areas.

The proposed assessments are shown in Attachment 2.

Fiscal Impact:

The projected revenue, expenditures, and cash balance, which include capital reserve, for the Districts are as follows:

<u>District</u>	<u>Revenue</u>	<u>Expenditures</u>	<u>Projected Reserve Fund Balance as of 7/1/20*</u>
2	\$77,888	\$76,419	(\$334)
3	\$10,000	\$10,055	\$17,119
4	\$150,353	\$148,790	\$88,884
5	\$456,562	\$515,489	\$398,752
6	\$24,924	\$20,622	\$107,005

**The Projected Reserve Fund Balance is the total of the Capital Replacement Reserve plus the Operating Reserve.*

Over this fiscal year, the City may be required to reduce maintenance levels in Zones of Benefit 2A, and 5B, or find alternative funding sources to maintain previous years' level of maintenance.

Alternatives:

1. Direct the modification of the assessment amounts, which will affect future revenue and expenditure amounts in FY 19/20.
2. Cancel the Districts and find alternative funding sources to maintain the streetlights and/or landscaping.

Recommendation:

Adopt a resolution confirming and ordering the annual levy of assessments for fiscal year 19-20 for the Yuba City Lighting and Landscape Maintenance District Nos. 2, 3, 4, 5, & 6 (Town Center, 69 subdivisions throughout Yuba City including the Palisades Subdivisions and Butte Vista neighborhood, and commercial district)

Attachments:

1. Resolution
2. Proposed Assessments
3. District Maps

Prepared by:

/s/ Joshua Wolfe

Joshua Wolfe
Assistant Engineer

Submitted by:

/s/ Diana Langley

Diana Langley
Interim City Manager

Reviewed by:

Department Head

BM

Finance

RB

City Attorney

SLC by email

ATTACHMENT 1

RESOLUTION NO. _____

**A RESOLUTION OF THE CITY COUNCIL OF THE CITY OF YUBA CITY
CONFIRMING AND ORDERING THE ANNUAL LEVY OF ASSESSMENTS FOR
FISCAL YEAR 19-20 FOR THE YUBA CITY LIGHTING AND LANDSCAPE
MAINTENANCE DISTRICT NOS. 2, 3, 4, 5, & 6 (TOWN CENTER, 69 SUBDIVISIONS
THROUGHOUT YUBA CITY INCLUDING THE PALISADES SUBDIVISIONS AND
BUTTE VISTA NEIGHBORHOOD, AND COMMERCIAL DISTRICT)**

WHEREAS, on July 16, 2019, pursuant to the provisions of the Landscaping and Lighting Act of 1972, Part 2 of Division 15 of the Streets and Highways Code (commencing with Section 22500) (the "Act"), the City Council of the City of Yuba City did declare its intention to review, levy and collect the annual assessment for Yuba City Lighting and Landscape Maintenance District Nos. 2, 3, 4, 5, and 6 ("Districts") for fiscal year 2019-20 more specifically as follows:

- Lighting and Landscape Maintenance District No. 2 – Zone of Benefit "A" (Town Center);
- Lighting and Landscape Maintenance District No. 3 – Zone of Benefit "A" (Palisades Subdivision);
- Lighting and Landscape Maintenance District No. 4 – Zones of Benefit "A," "B," "C," and "D" (Butte Vista Neighborhood);
- Lighting and Landscape Maintenance District No. 5 – Zones of Benefit "A," "B," "C," "D," "E," "F," "G," "H," "I," "J," "K," and "L";
- Lighting and Landscape Maintenance District No. 6 – Zones of Benefit "A_1," "A_2" and "A_3," and Zones of Benefit "B_1," "B_2," "B_3," "B_4," "B_5," "B_6," "B_7," "B_8," "B_9," "B_10," "B_12," and "B_13."

; and

WHEREAS, assessments levied within the Districts provided revenue for the purpose of financing the installation, construction, and maintenance of certain public projects eligible under the Act, including without limitation the following:

- Lighting and Landscape Maintenance District No. 2: Ongoing maintenance and servicing of landscaping material, irrigation systems, and street lighting in the Town Center Area along the frontage of Plumas Street (including median), C Street, Percy Avenue, B Street and Franklin Avenue.
- Lighting and Landscape Maintenance District No. 3: Ongoing maintenance and servicing of a detention pond, street trees and a pond landscape strip, and twelve street lights, which benefit parcels in Phases 1 and 2.
- Lighting and Landscape Maintenance District No. 4: Ongoing maintenance and servicing of local street lighting and landscaping improvements providing special benefit to the Butte Vista Neighborhood in the subdivisions in zones of benefit as shown on the Assessment Diagrams on file with the City Clerk.
- Lighting and Landscape Maintenance District No. 5: Street lights, walls, landscape strips and planters, street trees, and landscaped entrance varying by zones of benefit as shown on the Assessment Diagrams on file with the City Clerk.
- Lighting and Landscape Maintenance District No. 6: Ongoing maintenance and servicing of street lights, street trees and median landscaping.

; and

WHEREAS, said Council did declare its intention to levy and collect the annual assessment for the maintenance and operation of the lighting and landscaping facilities in said Districts; and

WHEREAS, on July 16, 2019, pursuant to the provisions of the Act, the City Council initiated proceedings by Resolution No. 19-058 for the levy and collection of assessments against the assessable lots and parcels of land in the Districts for Fiscal Year 2019-20 and directed the Engineer of Work, Richard Kopecky of Willdan Financial Services, to prepare and file a written report in accordance with Article 4 (commencing with Section 22565) of Chapter 1 of the Act; and

WHEREAS, in accordance with Article 4 of Chapter 1 of the Act, the Engineer of Work prepared and filed such report for each Lighting and Landscape Maintenance District (the "Engineer's Reports") with the City Clerk, and the City Clerk has presented the Engineer's Reports to the City Council; and

WHEREAS, on July 16, 2019, the City Council adopted Resolution No. 19-060 approving the Engineer's Reports, which calculated the annual assessments for the parcels in said Districts, as filed pursuant to Section 22623 of the Act, and

WHEREAS, the public notice of the Resolution of Intention and the Public Hearing scheduled for August 20, 2019, was duly published on August 8, 2019.

NOW, THEREFORE, be it resolved by the City Council of the City of Yuba City as follows:

Section 1. The above recitals are true and correct, and are hereby incorporated herein by this reference.

Section 2. The City Council hereby (1) finds that the public interest and convenience requires and (2) declares its intention to order the levy of and to collect assessments against the assessable lots and parcels of property within existing assessment districts designated "Yuba City Lighting and Landscape Maintenance District No. 2", "Yuba City Lighting and Landscape Maintenance District No. 3", "Yuba City Lighting and Landscape Maintenance District No. 4", "Yuba City Lighting and Landscape Maintenance District No. 5", and "Yuba City Lighting and Landscape Maintenance District No. 6" (the "Districts") pursuant to the provisions of the Act, for the fiscal year commencing July 1, 2019 and ending June 30, 2020, to pay for the costs and expenses of the improvements described in the Engineer's Reports for each District.

Section 3. That the City Council hereby determines that the territories within the Districts, whose boundaries are set forth in the Engineer's Reports, on file with the City Clerk of the City of Yuba City, will be the territories benefited by the maintenance and servicing of the improvements described in said Engineer's Reports.

Section 4. That the hearing on said annual levy of assessment was held in accordance with law and all persons desiring to speak were heard.

Section 5. That the Engineer's Reports, the diagram for the assessment districts and the assessment of the estimated costs of the improvements contained therewith and each and every part of said Reports, is adopted and approved as to each District and all of them, and that the assessment of the total amount of the costs and the individual assessments thereof, respectively, from said improvements, and of the expenses incidental thereto, be and the same hereby are finally approved and confirmed as the assessments to pay the costs. The assessment for District No. 2 for fiscal year 2019-20 is proposed to remain the same as the previous year as described in the Engineer's Report. The assessments for District Nos. 3-6 for fiscal year 2019-20 are proposed to increase from the previous year as described in the Engineer's Reports, but are still within or less than the amount approved for each District at the time of its formation.

Section 6. The Council hereby orders the levy of the assessments described in said Resolution of Intention and the Engineer's Reports.

Section 7. That the assessment diagram showing the assessment districts referred to in said Resolution of Intention, and also the subdivision of land within the Districts, as contained in said Engineer's Reports, be and it is hereby finally approved and confirmed as the diagram of the properties to be assessed to pay the costs of the improvements.

Section 8. The City Clerk shall file the diagram and assessment, as confirmed or certified copy thereof, with the Sutter County Auditor-Controller no later than August 21, 2019.

Section 9. Although the levies have increased for District Nos. 2-6 as compared to the prior year, the levy amounts are consistent with and less than the previously approved COLA adopted at the time of formation of the Districts pursuant to Proposition 218, and as such, the levies for District Nos. 2-6 are exempt from the requirements of Article XIII Section "D" of the California Constitution (Proposition 218).

The foregoing resolution was duly and regularly introduced, passed, and adopted by the City Council of the City of Yuba City at a regular meeting thereof held on the 20th day of August 2019.

AYES:

NOES:

ABSENT:

Shon Harris, Mayor

Patricia Buckland, City Clerk

APPROVED AS TO FORM
COUNSEL FOR YUBA CITY

Shannon L. Chaffin, City Attorney
Aleshire & Wynder, LLP

ATTACHMENT 2

EXHIBIT A



District	Zone of Benefit	FY 2019/20 Proposed Levy Rate (\$)	Change From Previous Year (\$)	Maximum Levy Rate Allowed (\$)
2	A	\$579.74	\$8.85	\$579.74
3	A	\$113.64	\$33.10	\$164.86
4	A	\$261.48	\$52.30	\$431.64
	B	\$261.48	\$52.30	\$584.57
	C	\$261.48	\$52.30	\$354.70
	D	\$261.48	\$52.30	\$317.79
5	A	\$210.33	\$64.09	\$210.33
	B	\$70.61	\$10.04	\$70.61
	C	\$101.28	(\$17.01)	\$152.44
	D	\$101.29	\$12.81	\$209.32
	E	\$86.45	\$41.25	\$86.45
	F	\$101.26	\$13.02	\$170.08
	G	\$53.18	\$3.76	\$53.18
	H	\$34.17	\$0.52	\$34.17
	I	\$71.65	\$7.32	\$71.65
	J	\$98.02	\$41.69	\$191.98
	K 1-17	\$220.47	\$42.73	\$271.62
	K 18	\$221.02	\$47.55	\$358.37
	L	\$126.60	\$25.49	\$126.60
6	A_1	\$292.78	\$4.47	\$292.78
	A_2	\$292.78	\$4.47	\$292.78
	A_3	\$292.78	\$4.47	\$292.78
	B_1	\$470.77	\$7.19	\$470.77
	B_2	\$432.55	\$6.60	\$432.56
	B_3	\$297.57	\$4.55	\$297.57
	B_4	\$1,570.47	\$23.99	\$1,570.47

6 cont'd	B_5	\$0.00	\$0.00	\$448.71
	B_6	\$86.53	\$1.32	\$86.53
	B_7	\$86.53	\$1.32	\$86.53
	B_8	\$197.83	\$3.02	\$197.83
	B_9	\$391.65	\$5.98	\$391.65
	B_10	\$127.52	N/A	\$127.52
	B_12	\$146.97	N/A	\$146.97
	B_13	\$133.47	N/A	\$133.47

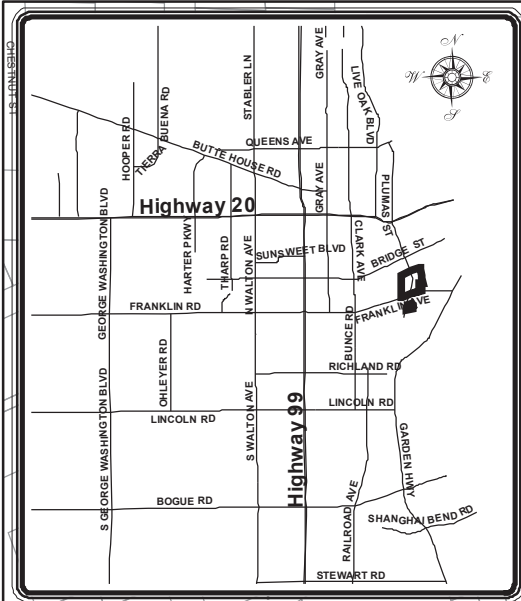
ATTACHMENT 3



Legend

-  Maintenance Districts
-  City Limits

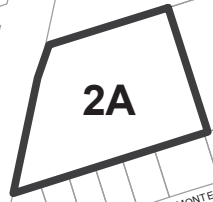
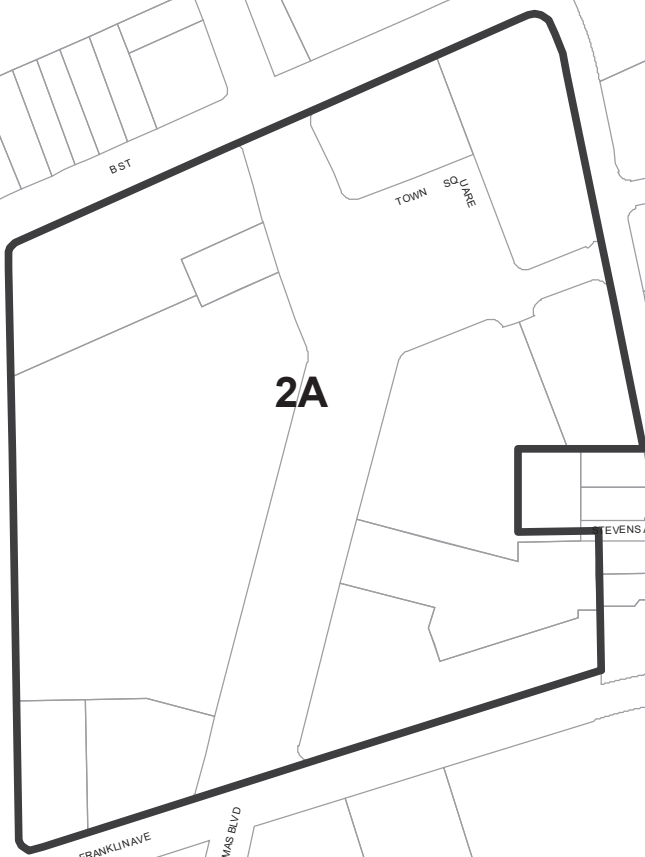

PRICE AVE
MAY HUGHES ST
ROBINSON AVE
PINE WAY
CAMPBELL WAY
MORTON ST
MAIN ST

WILLOW WAY
PALM AVE
BROOKS AVE
SPRUCE WAY
ELM ST
CAMPBELL WAY
PERCY AVE
FRANKL AVE
PLUMAS BLVD
FRANKLIN AVE
E TABER AVE
ROWE AVE
TABER AVE
JEWELL AVE
MORTON ST

SHASTA ST
PLUMAS ST
EMERSON ST
C ST
EVENS AVE
WILBUR AVE
WOODBRIDGE AVE
DOMIN AVE
WILSON AVE

**Lighting & Landscape
Maintenance District No. 2
Zones of Benefit**



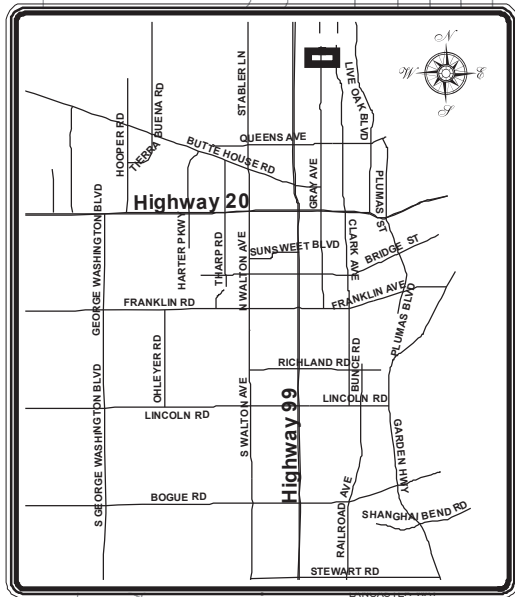

Legend

-  Maintenance Districts
-  City Limits

MAY 99

3A

**Lighting & Landscape
Maintenance District No. 3
Zones of Benefit**



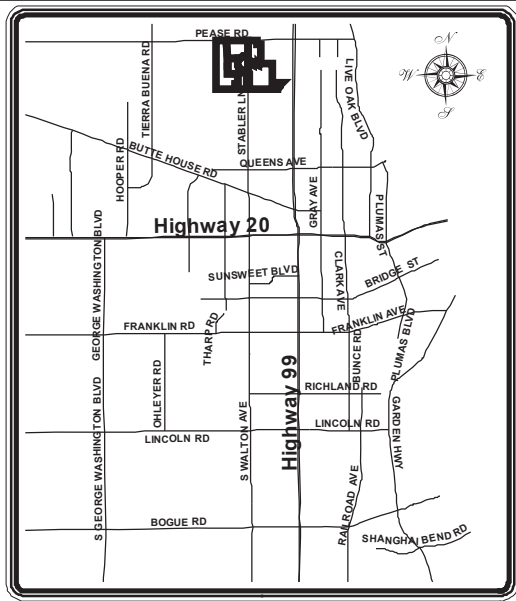

Legend

- Maintenance Districts
- City Limits

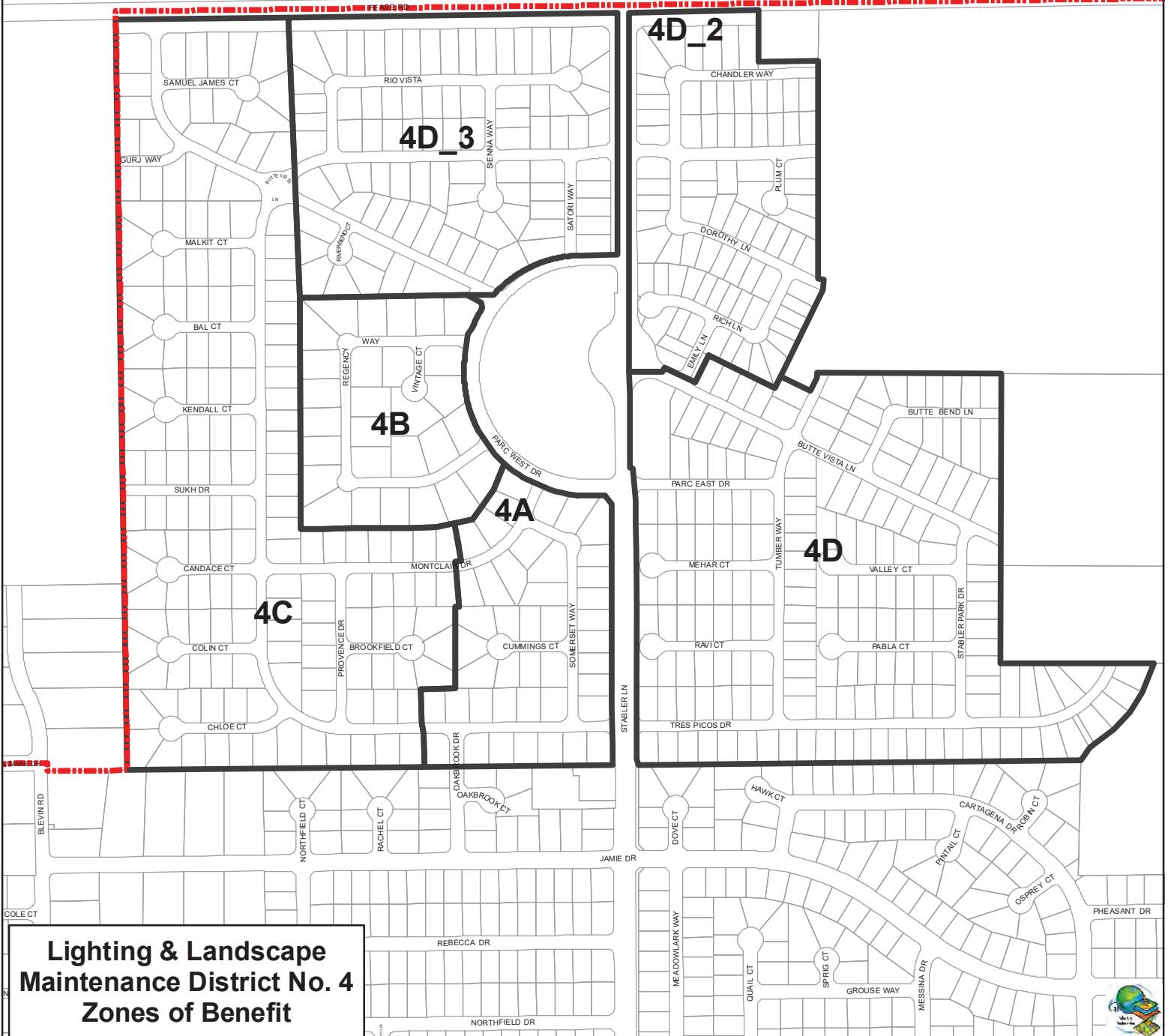

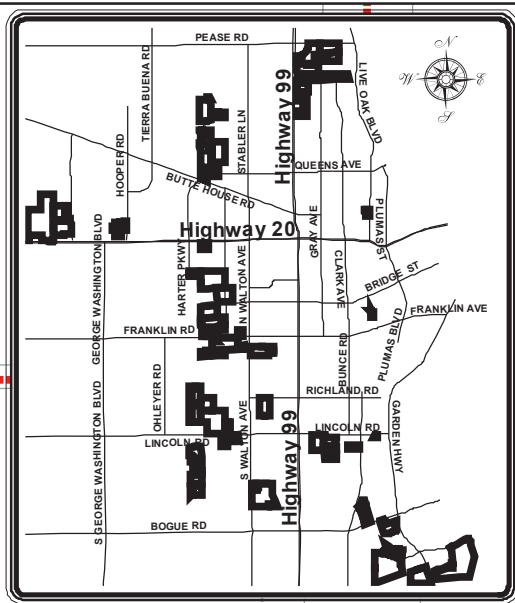

Legend

- Maintenance Districts
- City Limits

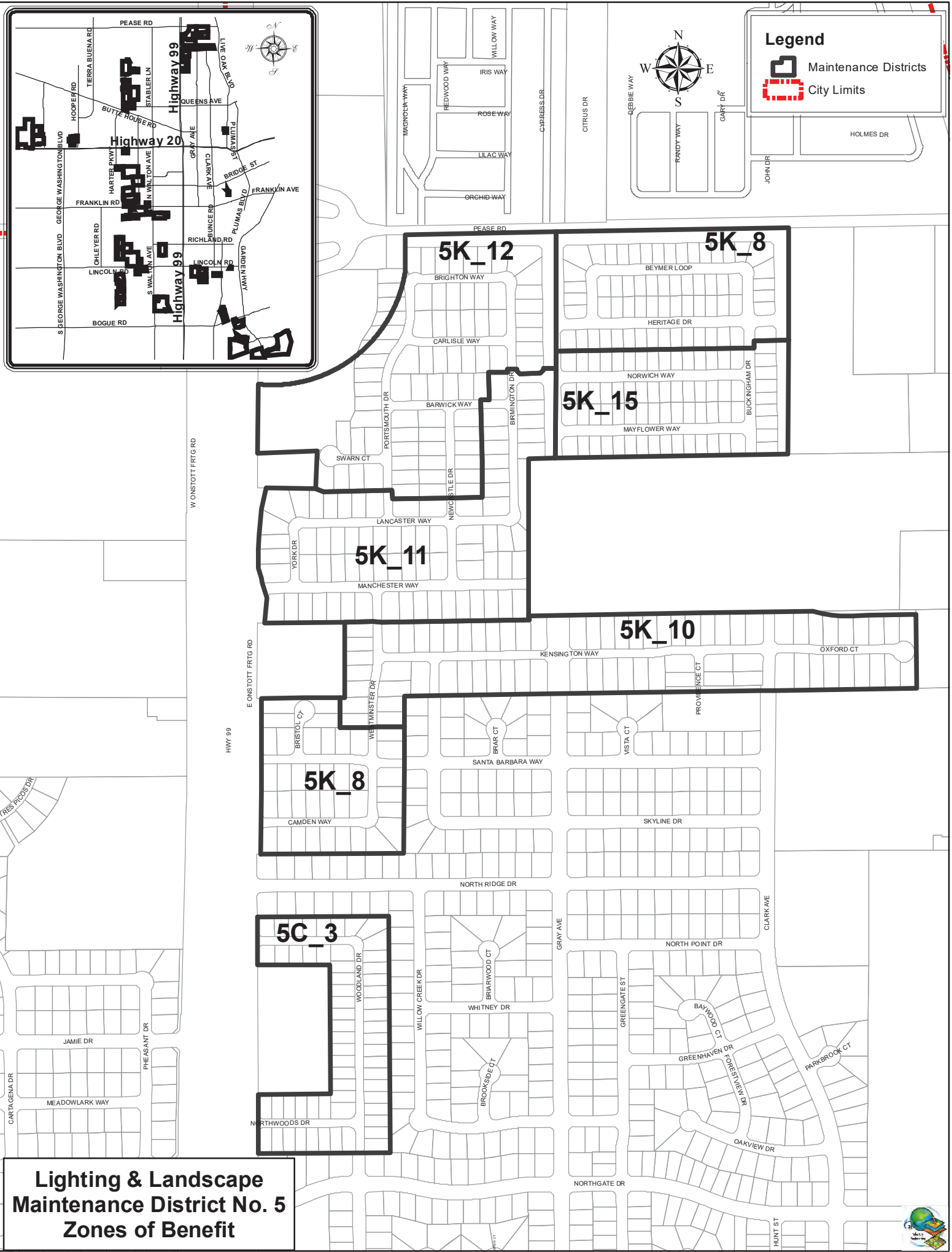
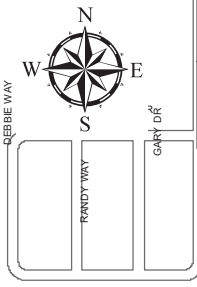

**Lighting & Landscape
Maintenance District No. 5
Zones of Benefit**



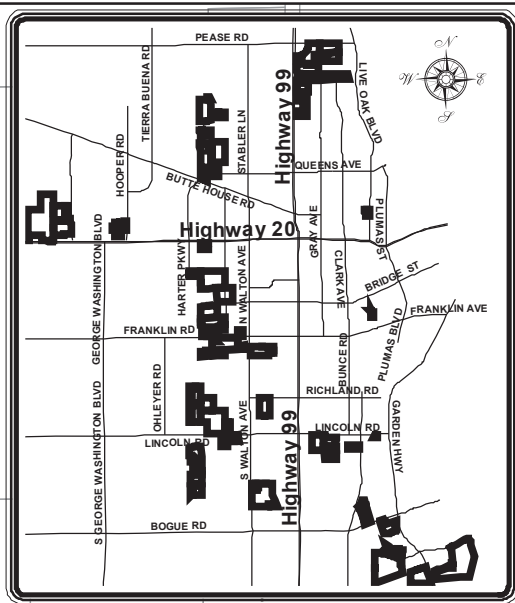

Legend

- Maintenance Districts
- City Limits





**Lighting & Landscape
Maintenance District No. 5
Zones of Benefit**

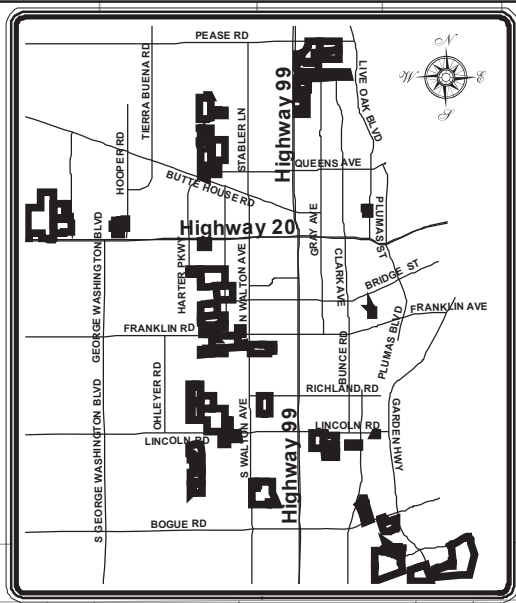



Legend

-  Maintenance Districts
-  City Limits

MONROE RD

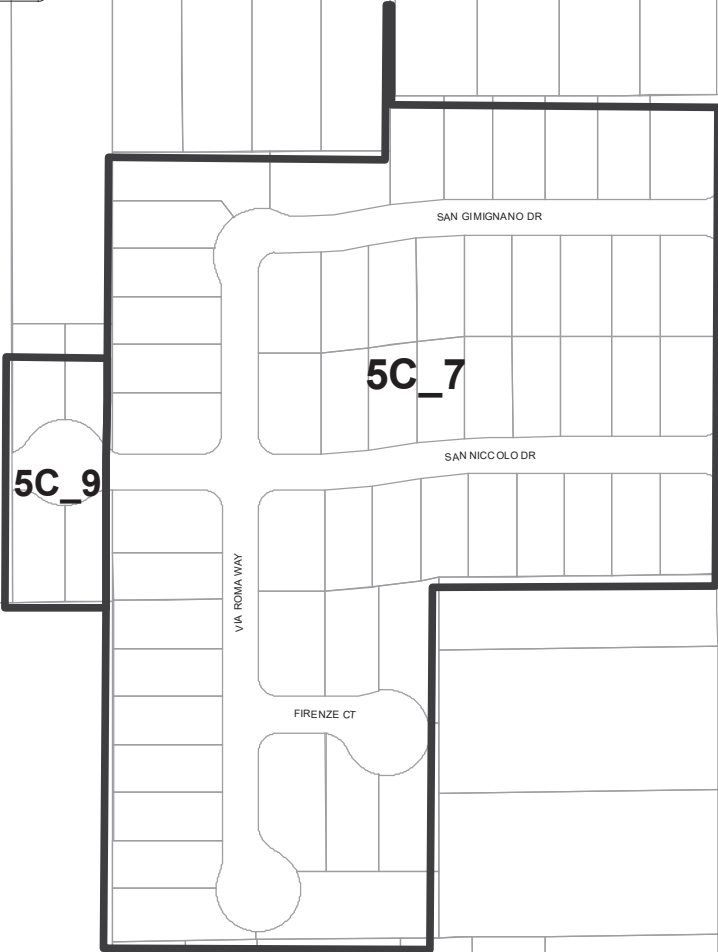

HOOPER RD

COLUSA FRONTAGE RD

HWY 20

MILLER RD

WASHINGTON BLVD

**Lighting & Landscape
Maintenance District No. 5
Zones of Benefit**



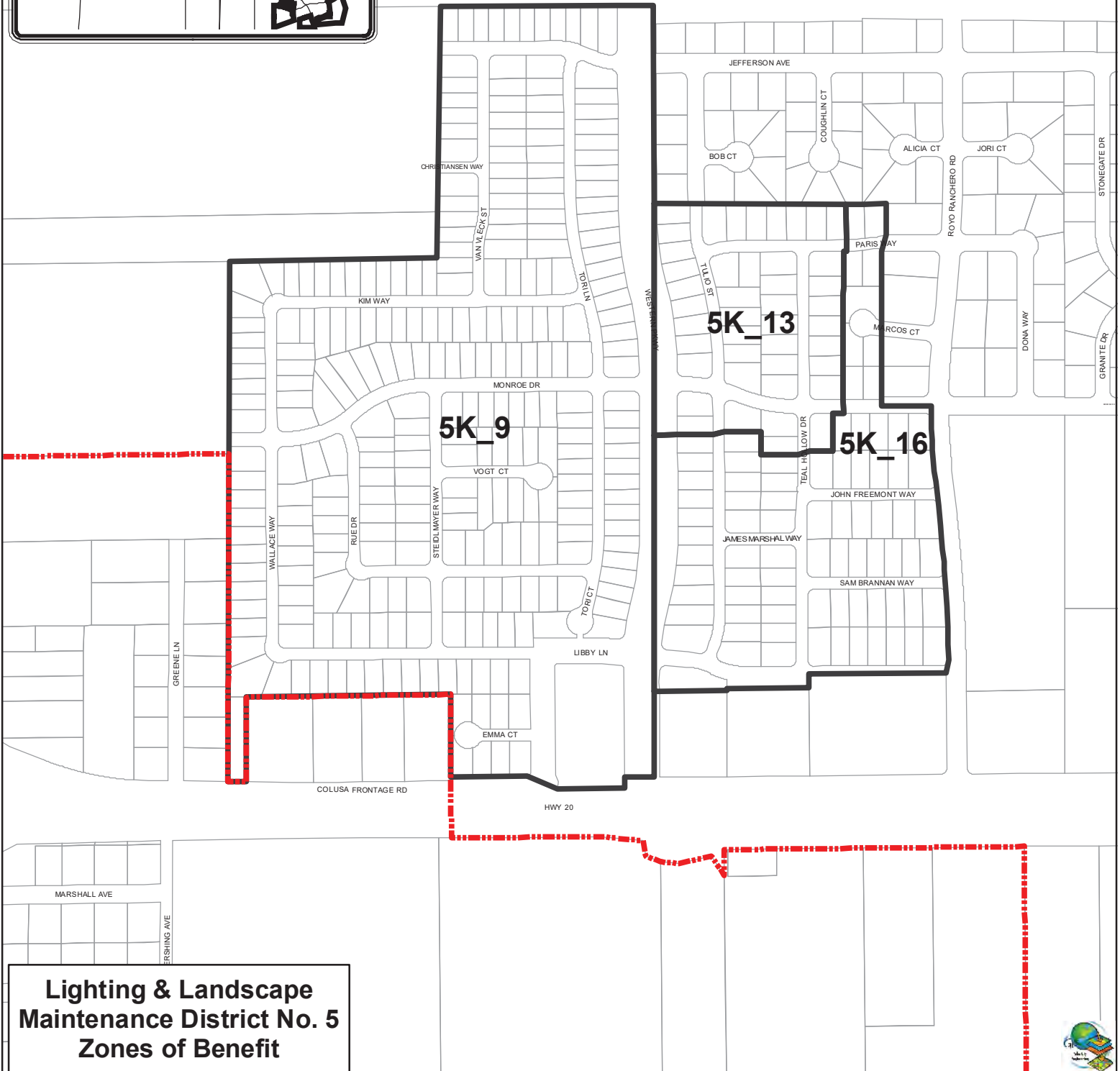
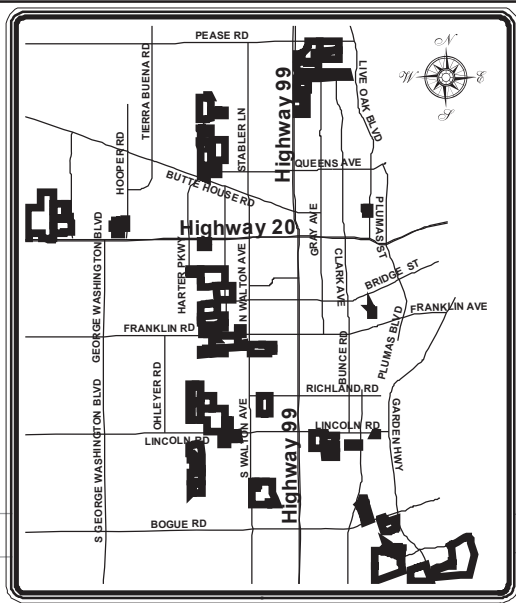

**Lighting & Landscape
Maintenance District No. 5
Zones of Benefit**



HARTER RD
SPIRIT DR
HARTER PKWY

HWY 20



Legend

- Maintenance Districts
- City Limits

5H_8

SIERRA AVE

5K_9

5K_5

RYAN DR
CARSON DR
REDAVEN AVE
SANTO CT
BOYD CT
ROSS DR
KRAMT CT
DAVIS AVE
MONTE AVE
ANDROSS AVE

5K_7

EMMET WAY
TRAVIS CT
LACHARY WAY
MARK THOMAS DR

5K_4

HARBANS DR
EVEREST CT
DEERFIELD DR
AVARRAL CT

5K_1

HARDIAL DR
HUNJI DR
GORDAS CT
N OLIVER DR
HARDIAL CT

5K_3

5K_2

5H_3

NETHE
SUNSHINE
CLINTON

5B_1

5K_6

NEWPORT DR
LAMBERT CT
OLIVER DR
JASON CT
RALESTATES CT
YORKSHIRE WAY
BRISTOL WAY
COLLEGE HILL WAY
NANTUCKET WAY
BARRINGTON DR
SASSA DR

5H_1

MICHELLE DR
RAMERIZ DR
SIDE DR
SHAKEWOOD DR
SHAKENWOOD CT

5D

5E

COUNTRYSIDE DR
BERKSHIRE DR
CAMINO DEL ORO
HOLLY TREE DR

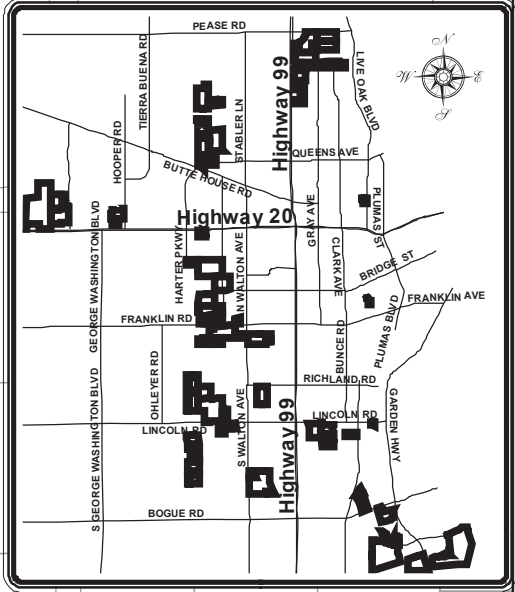



**Lighting & Landscape
Maintenance District No. 5
Zones of Benefit**

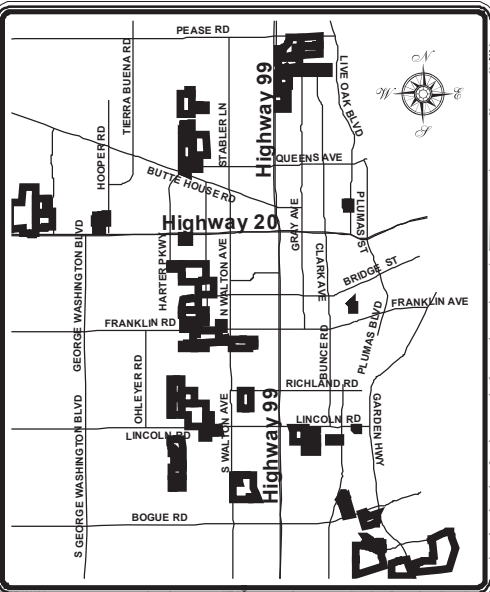



Legend

-  Maintenance Districts
-  City Limits



5J_13
5J_6

5I_2

5I_1

5I_3

5L

5H_2 **5H_7**

5J_1

5J_4

5J_5

5H_4

5C_8

5B_2



5K_17

**Lighting & Landscape
Maintenance District No. 5
Zones of Benefit**

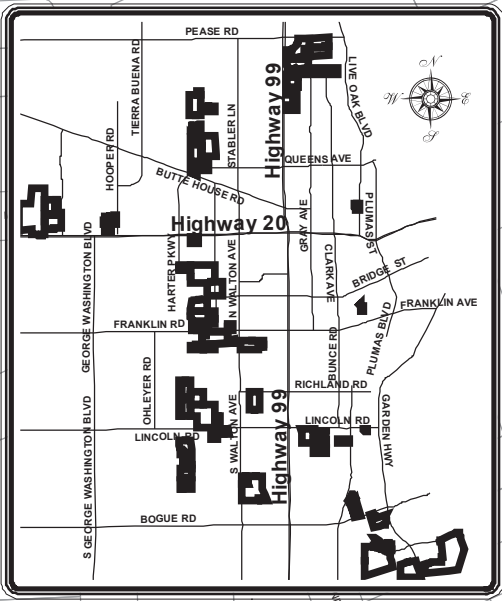



Legend

-  Maintenance Districts
-  City Limits

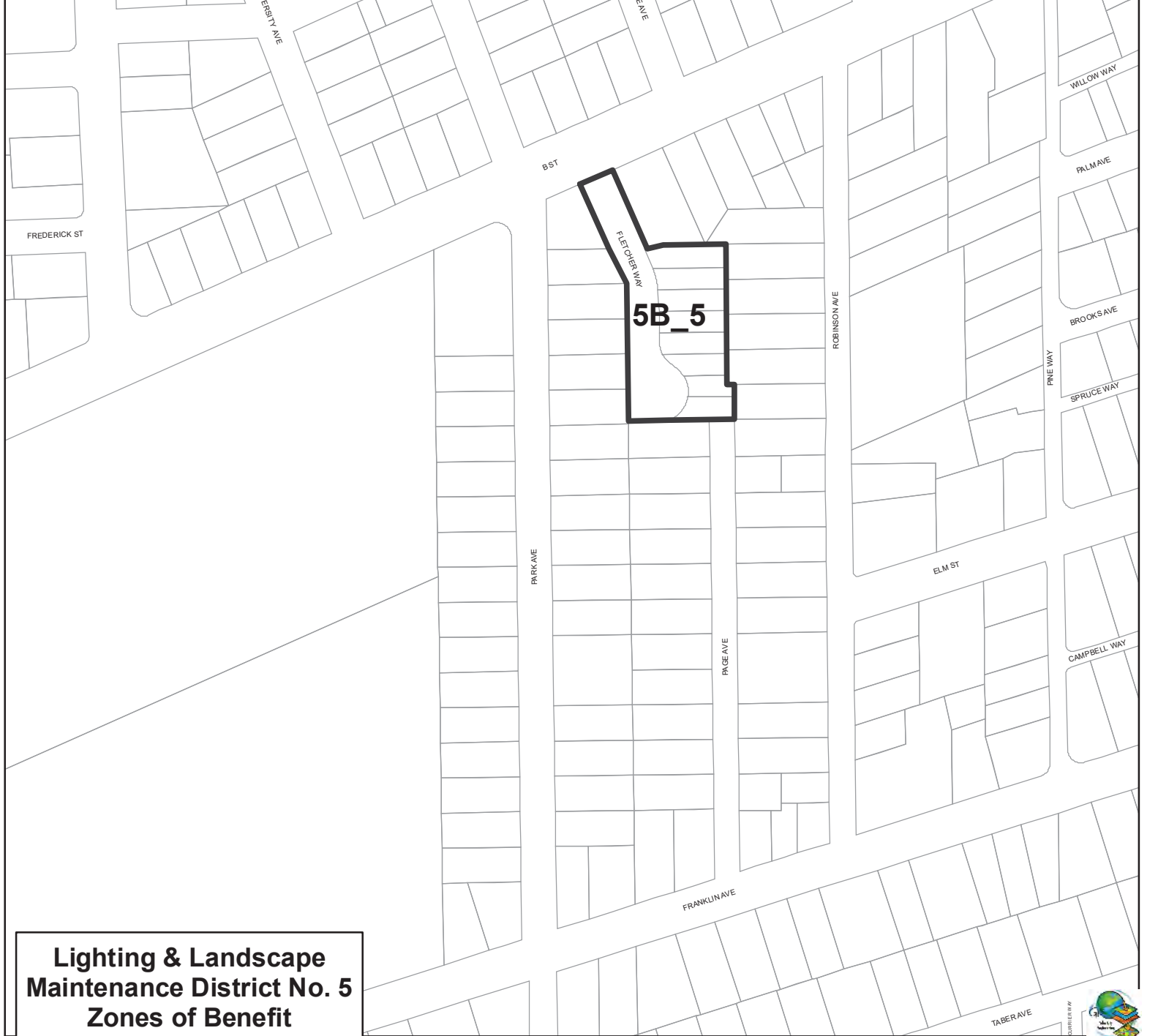

**Lighting & Landscape
Maintenance District No. 5
Zones of Benefit**

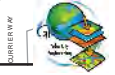

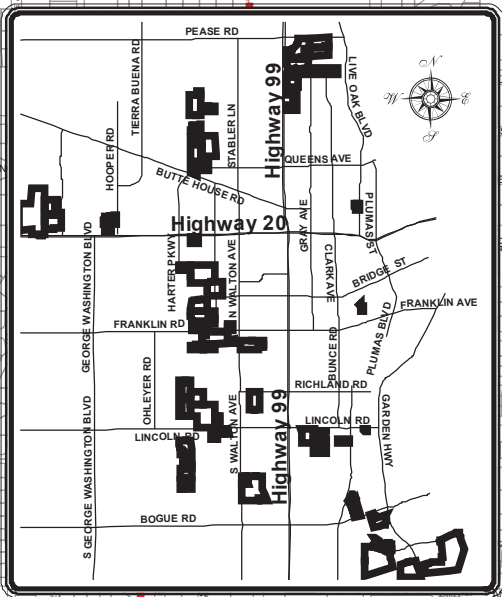

Legend

- Maintenance Districts
- City Limits



**Lighting & Landscape
Maintenance District No. 5
Zones of Benefit**



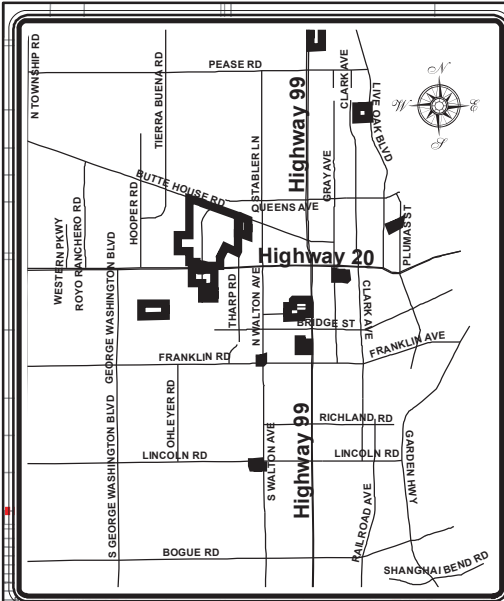

Legend

- Maintenance Districts
- City Limits

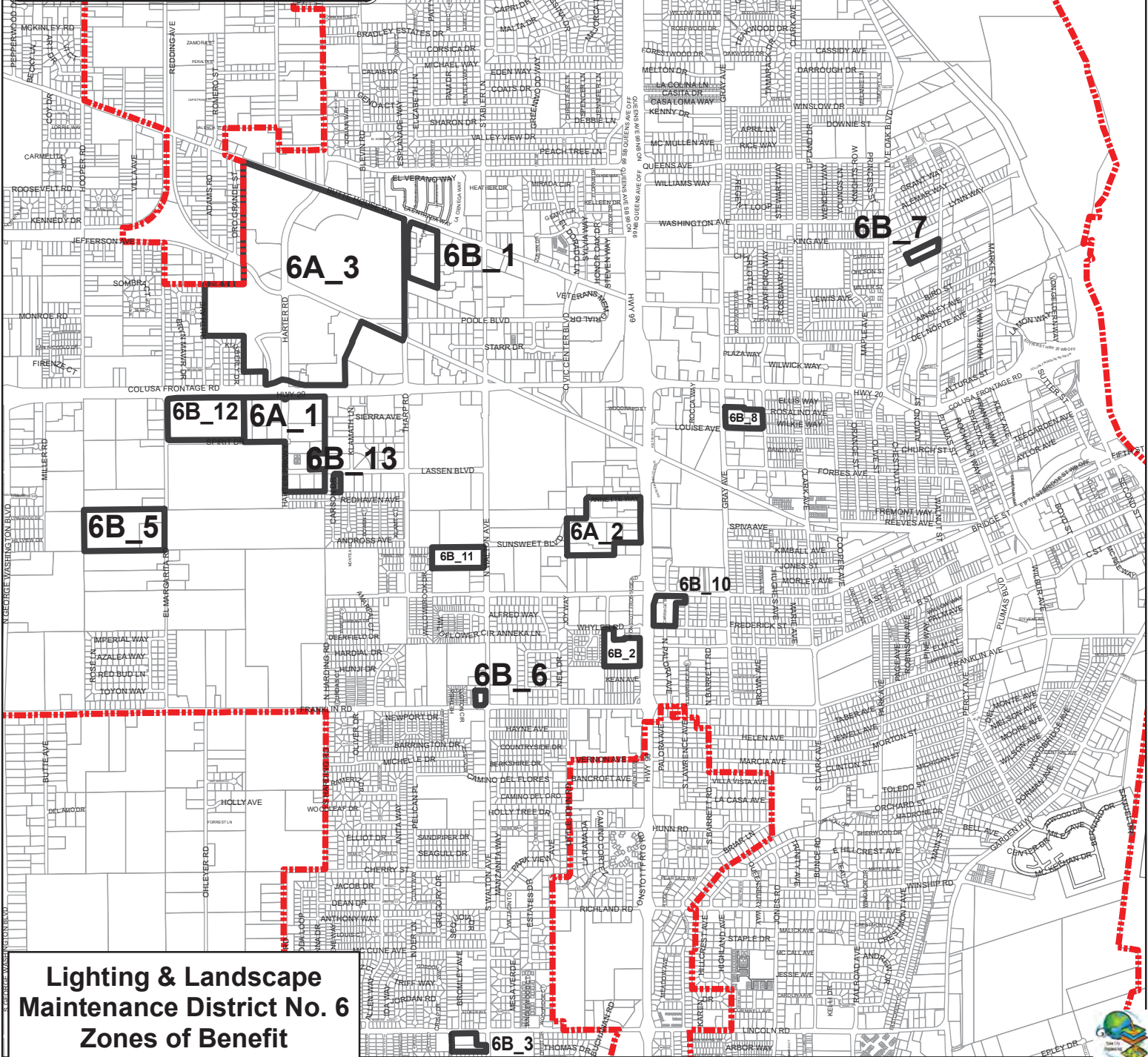
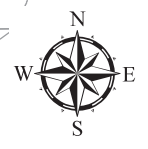

**Lighting & Landscape
Maintenance District No. 6
Zones of Benefit**

