



# **Yuba City Lighting and Landscape Maintenance Districts No. 1-6**

July 19, 2016

Presented By: Benjamin Moody

# Yuba City Lighting & Landscape Maintenance Districts

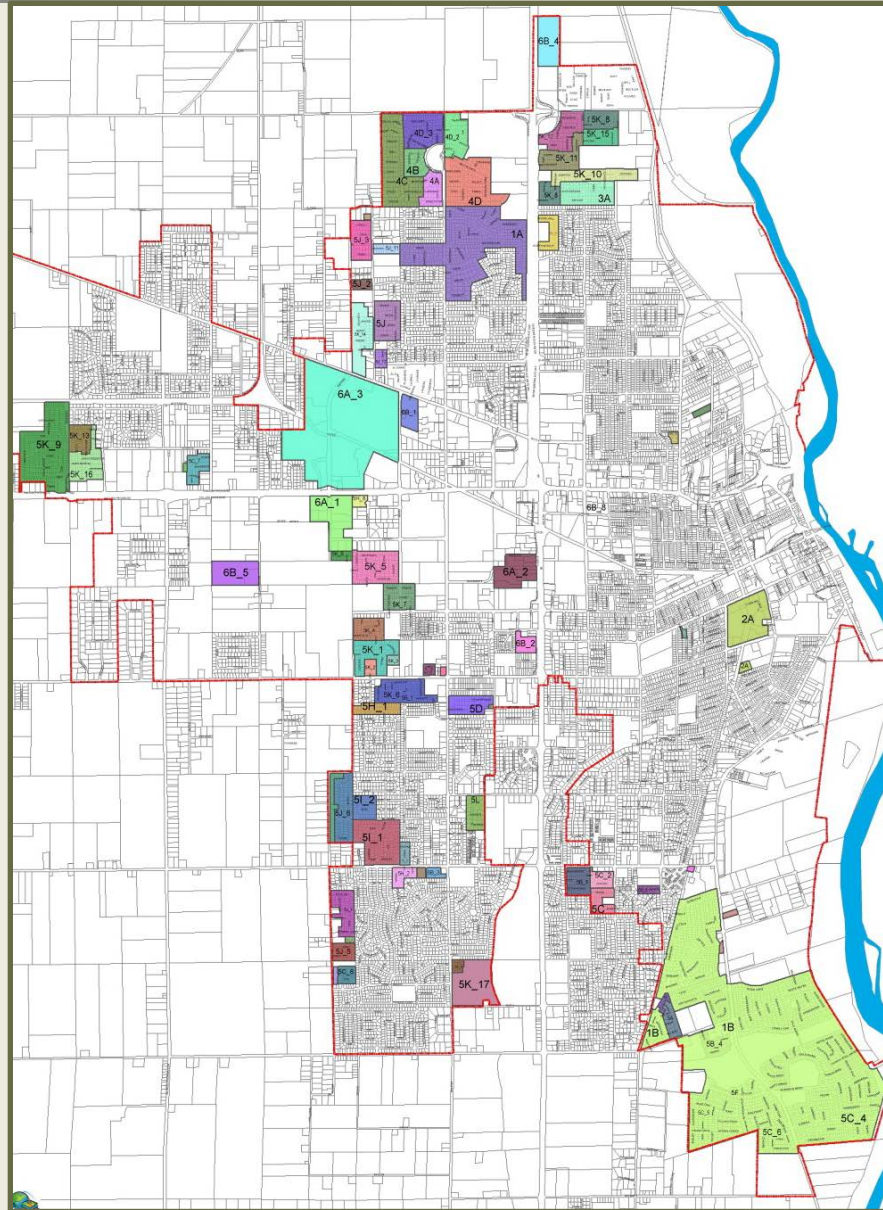

# Yuba City Lighting & Landscape Maintenance Districts



<u>District</u>	<u>Revenue</u>	<u>Expenditures</u>	<u>Projected Reserve Fund Balance as of 7/1/17*</u>
1	\$87,841	\$130,187	\$93,246
2	\$73,311	\$79,043	\$7,449
3	\$6,426	\$4,859	\$33,207
4	\$109,100	\$99,447	\$183,076
5	\$324,880	\$321,032	\$573,573
6	\$21,135	\$17,818	\$82,030

# Yuba City Lighting & Landscape Maintenance Districts



District	Zone of Benefit	FY 16/17 Proposed Levy (\$)	Change From Previous Year (\$)	Maximum Levy Allowed (\$)
1	A	56.72	0.00	56.72
	B	29.50	0.00	29.50
	B_1	30.53	0.00	30.53
2	A	545.67	5.51	545.67
3	A	73.02	1.43	155.17
4	A	189.74	0.21	406.27
	B	189.74	0.45	550.21
	C	189.74	0.05	333.85
	D	189.74	(0.09)	299.11
5	A	132.67	41.89	195.97
	B	54.94	0.00	66.46
	C	118.59	0.00	143.48
	D	88.71	(13.64)	197.02
	E	41.00	(23.50)	81.37
	F	90.78	0.00	160.09
	G	49.55	8.19	50.06
	H	31.84	5.26	32.16
	I	64.49	8.75	67.44
	J	56.47	(5.69)	180.69
	K	166.16	8.55	255.65
	L	99.44	12.85	119.16
6	A_1	275.57	2.78	275.57
	A_2	275.57	2.78	275.57
	A_3	275.57	2.78	275.57
	B_1	443.09	4.47	443.09

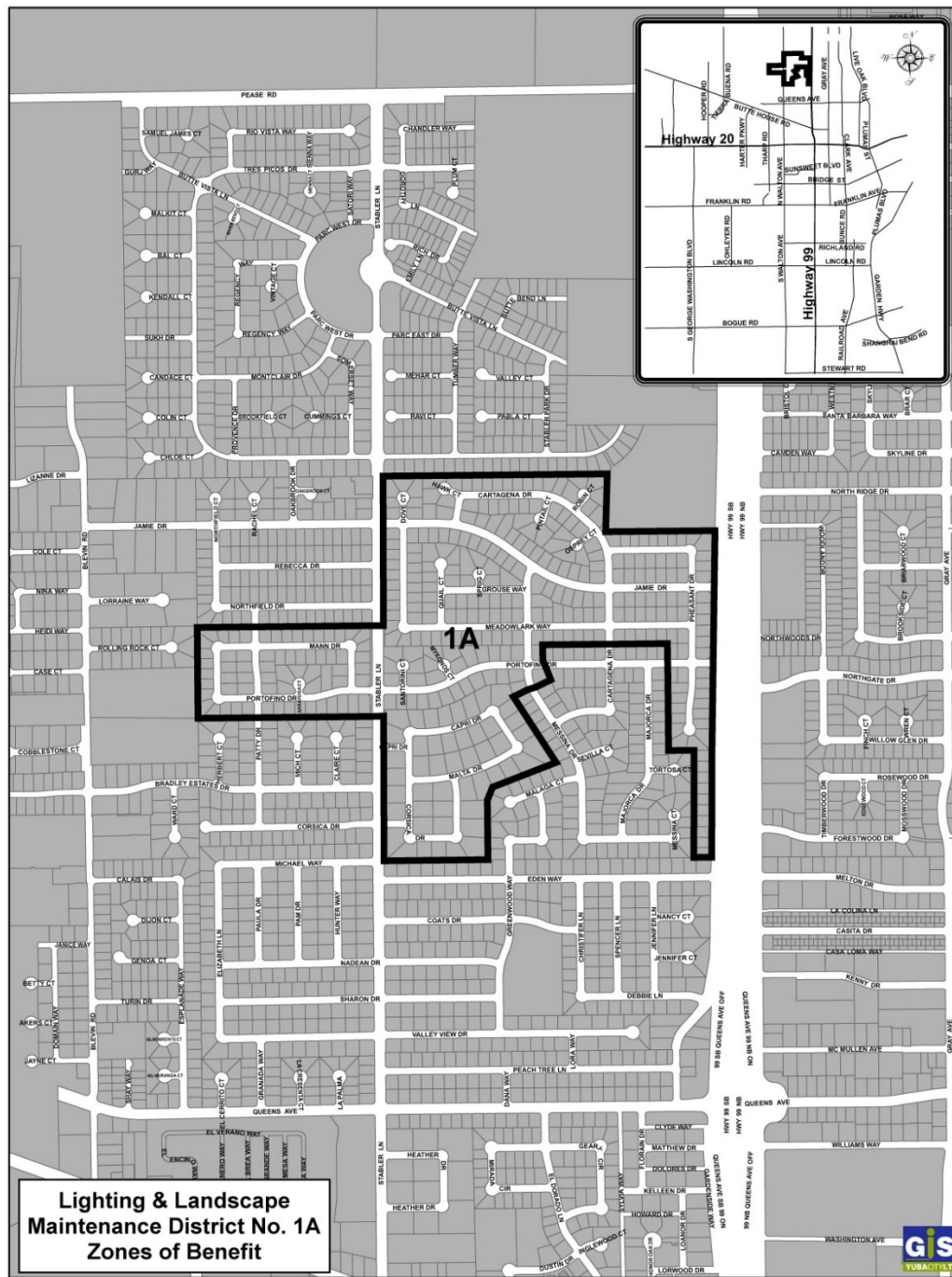



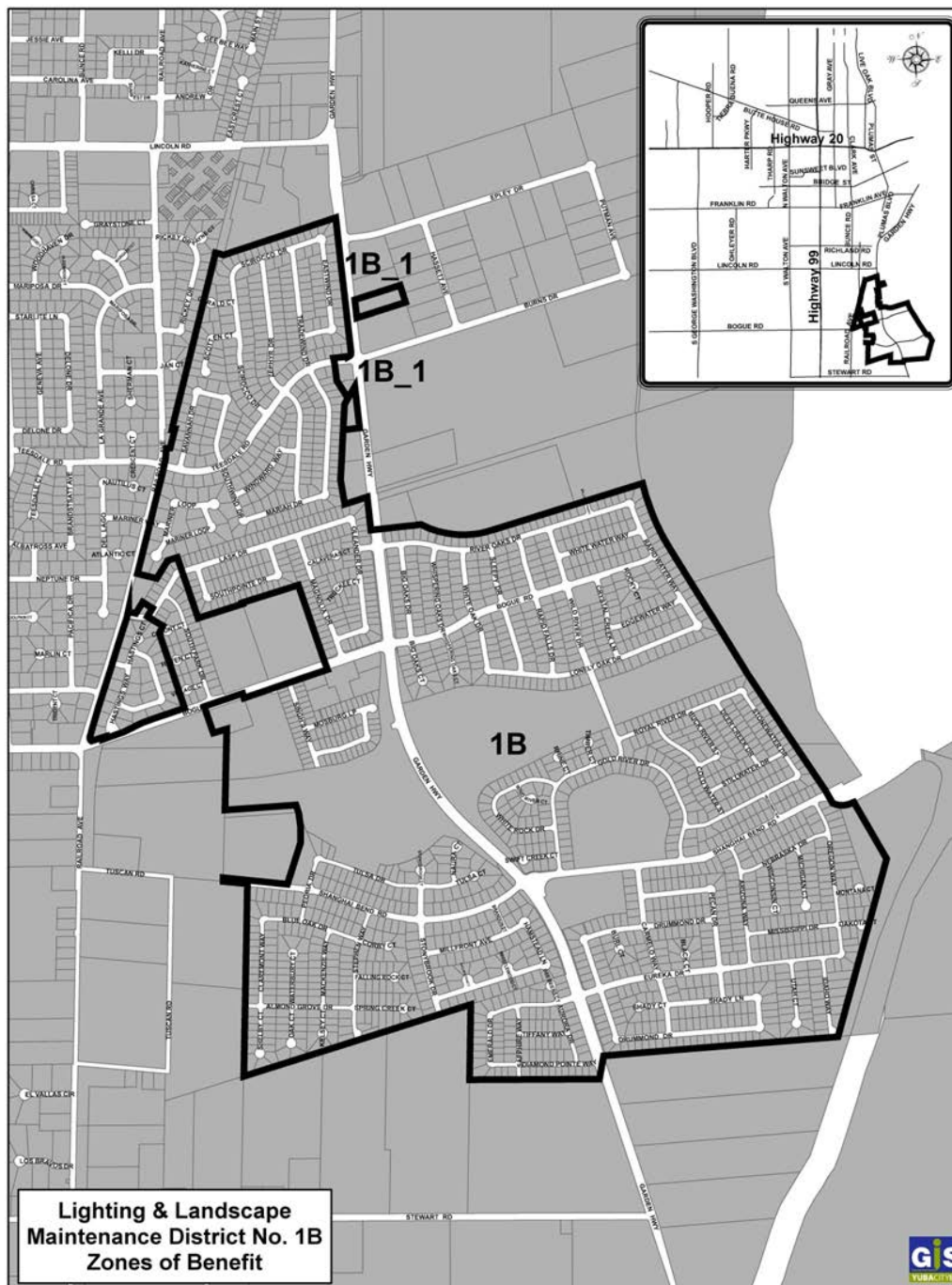

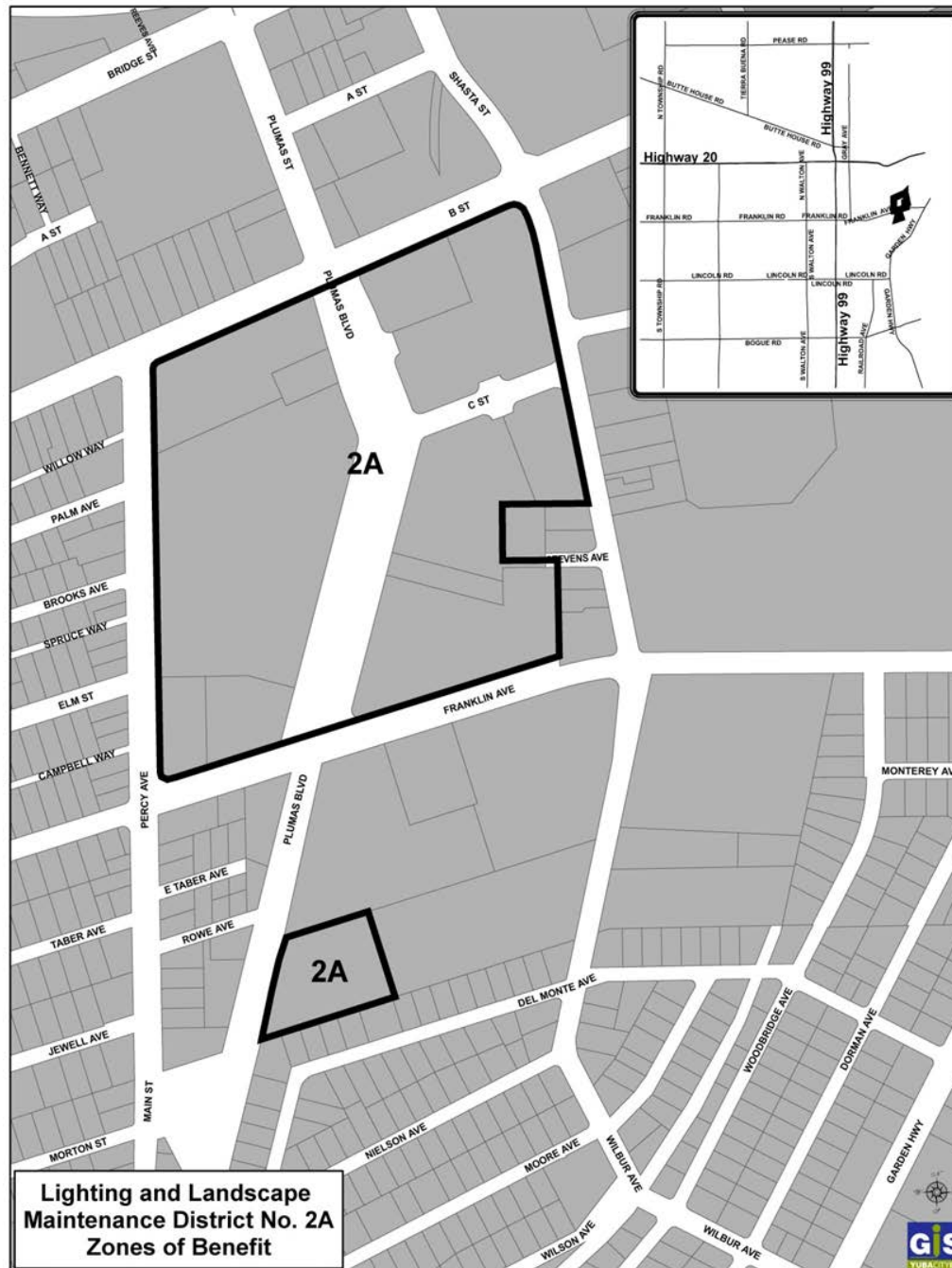

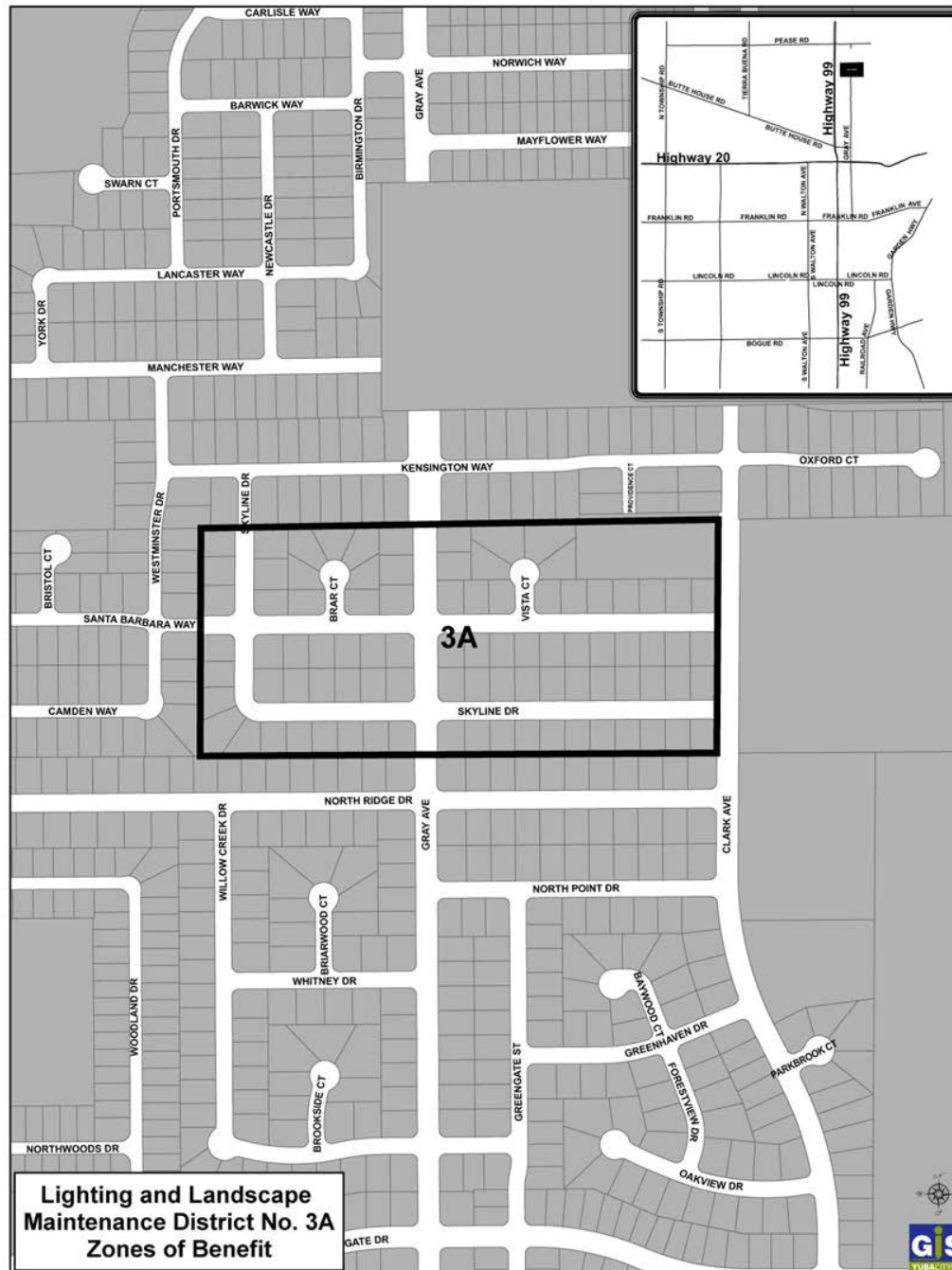

**Lighting and Landscape  
Maintenance District No. 3A  
Zones of Benefit**



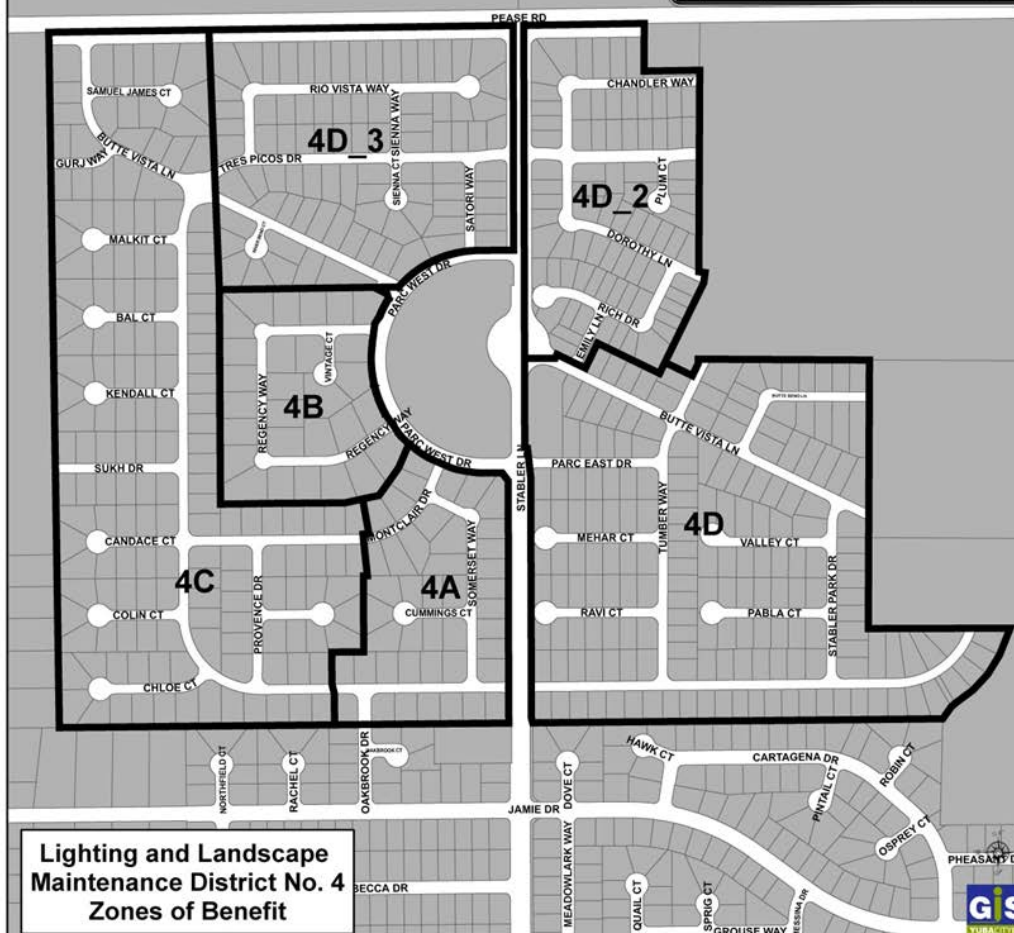
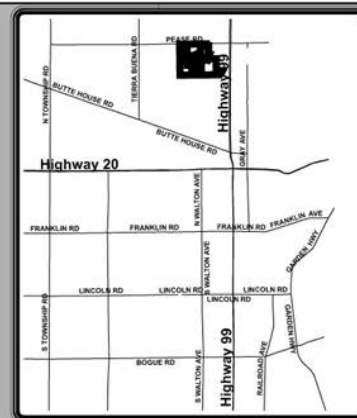

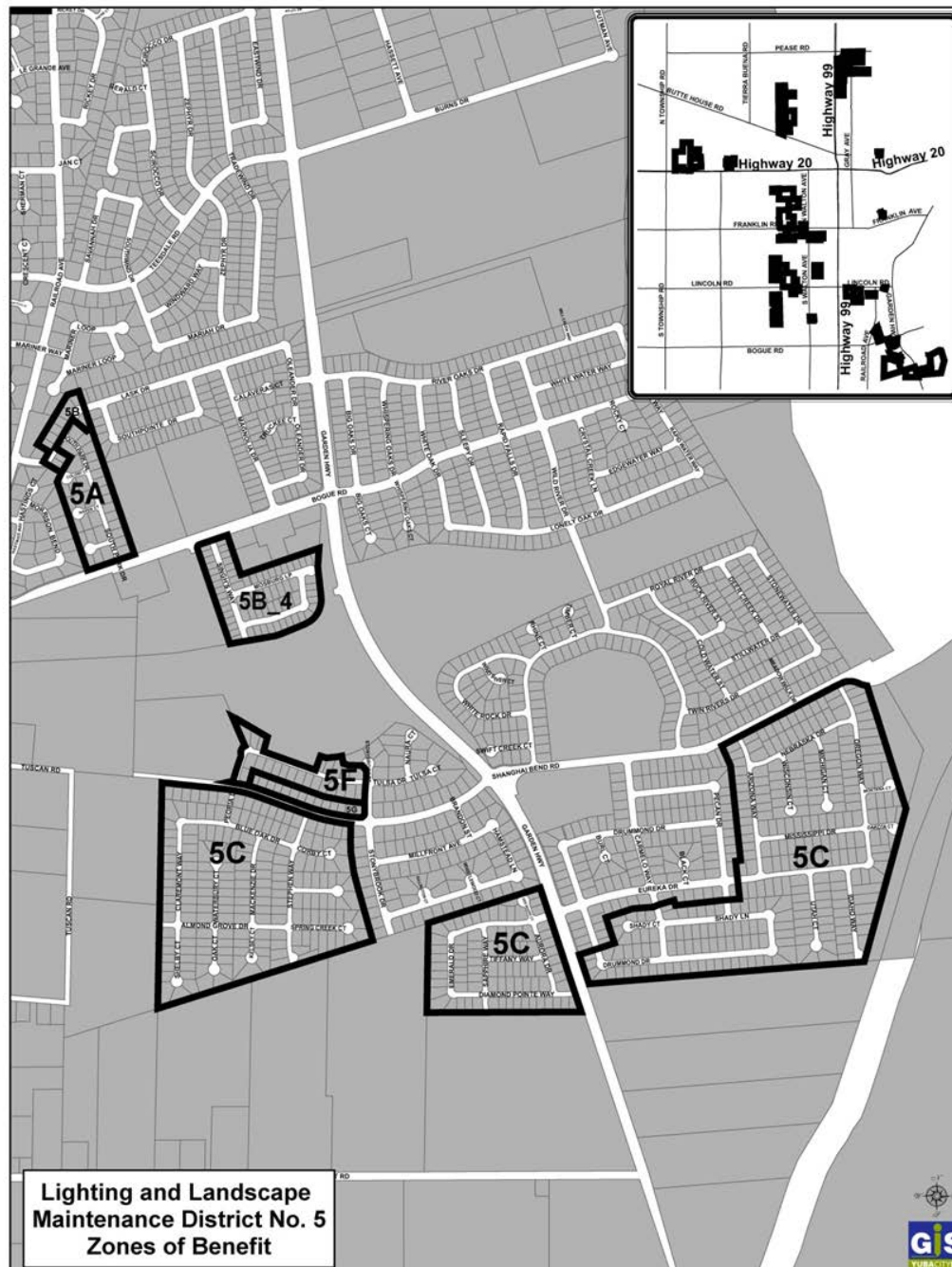

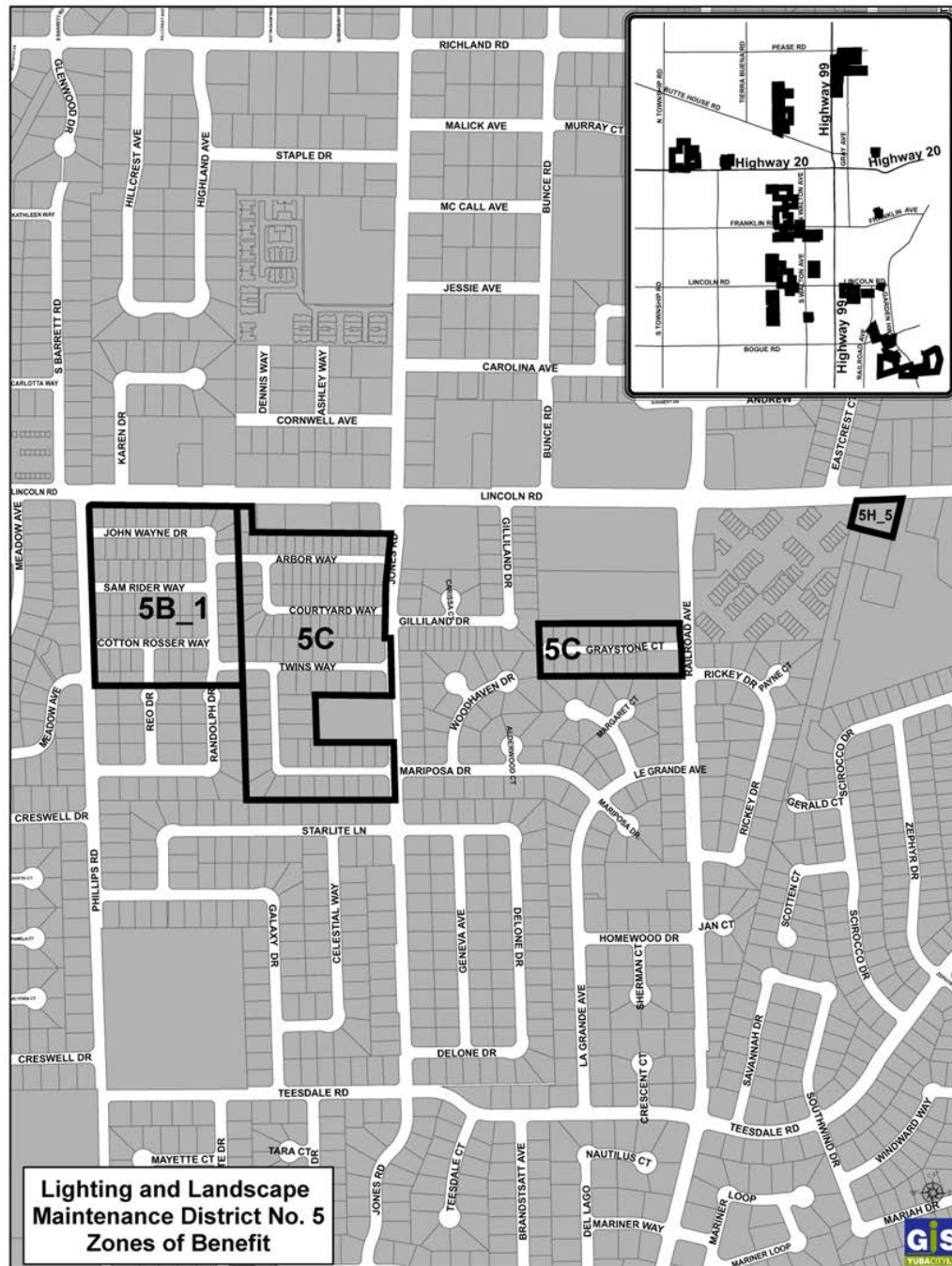

### Lighting and Landscape Maintenance District No. 5 Zones of Benefit

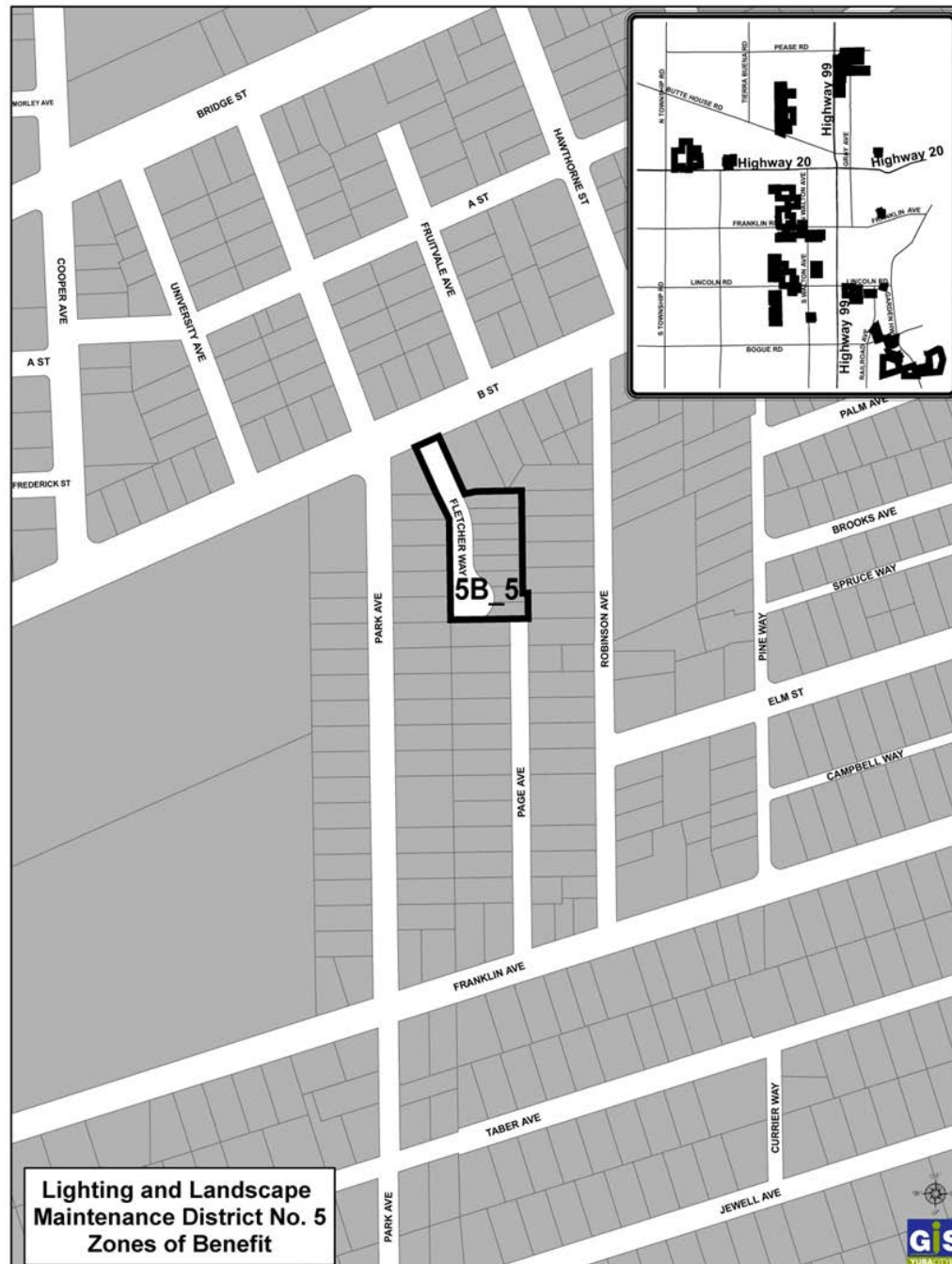



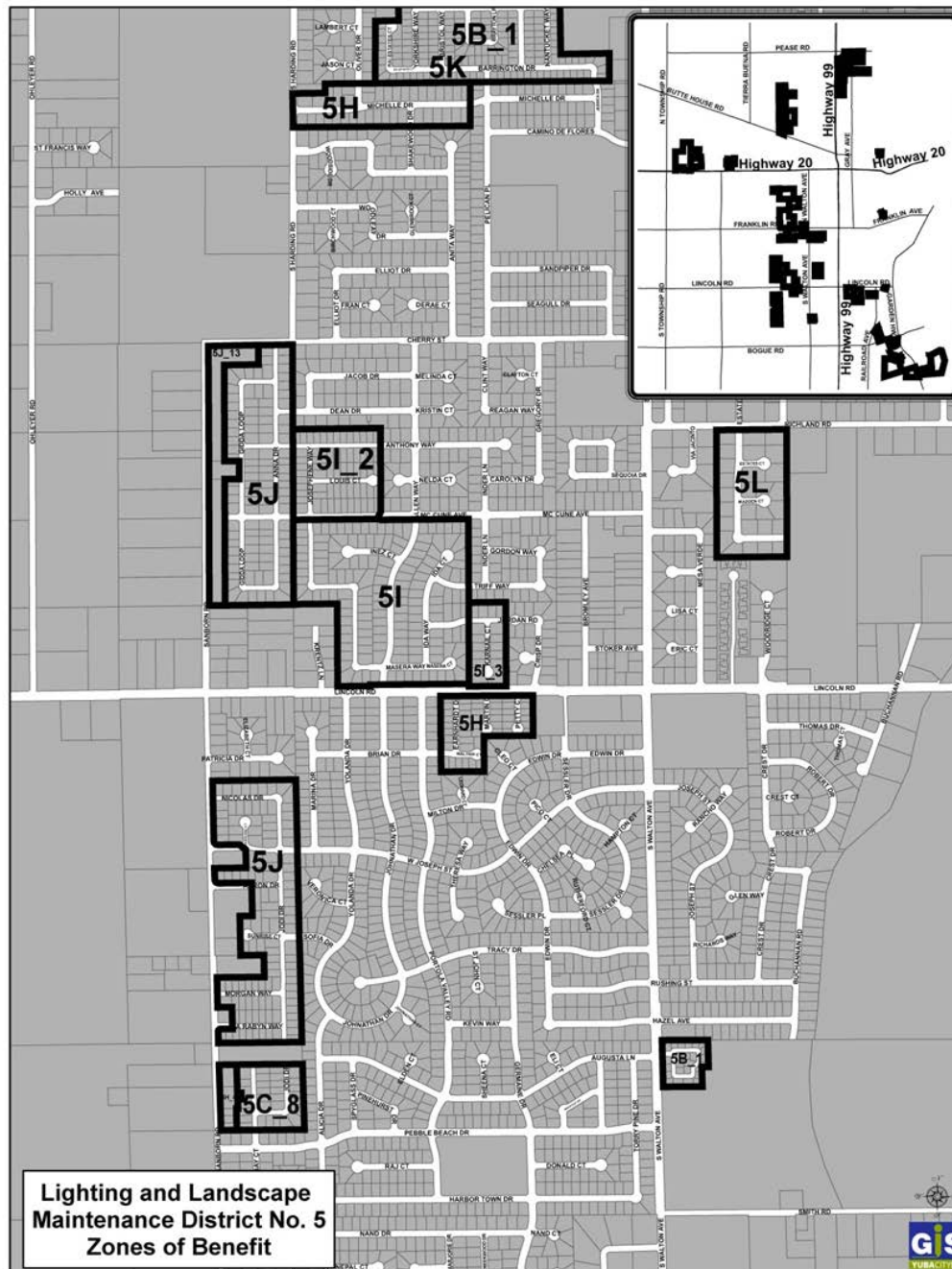



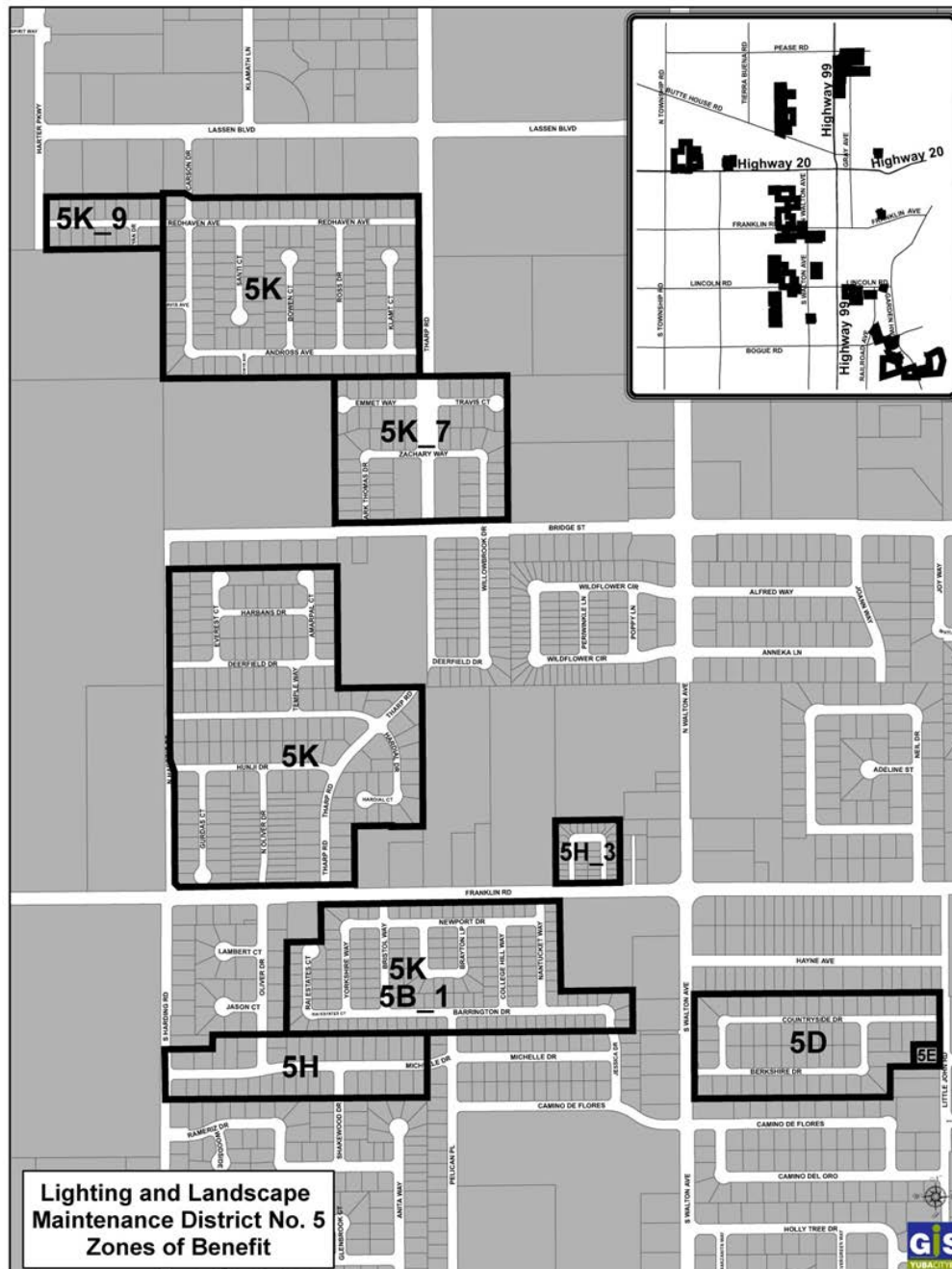

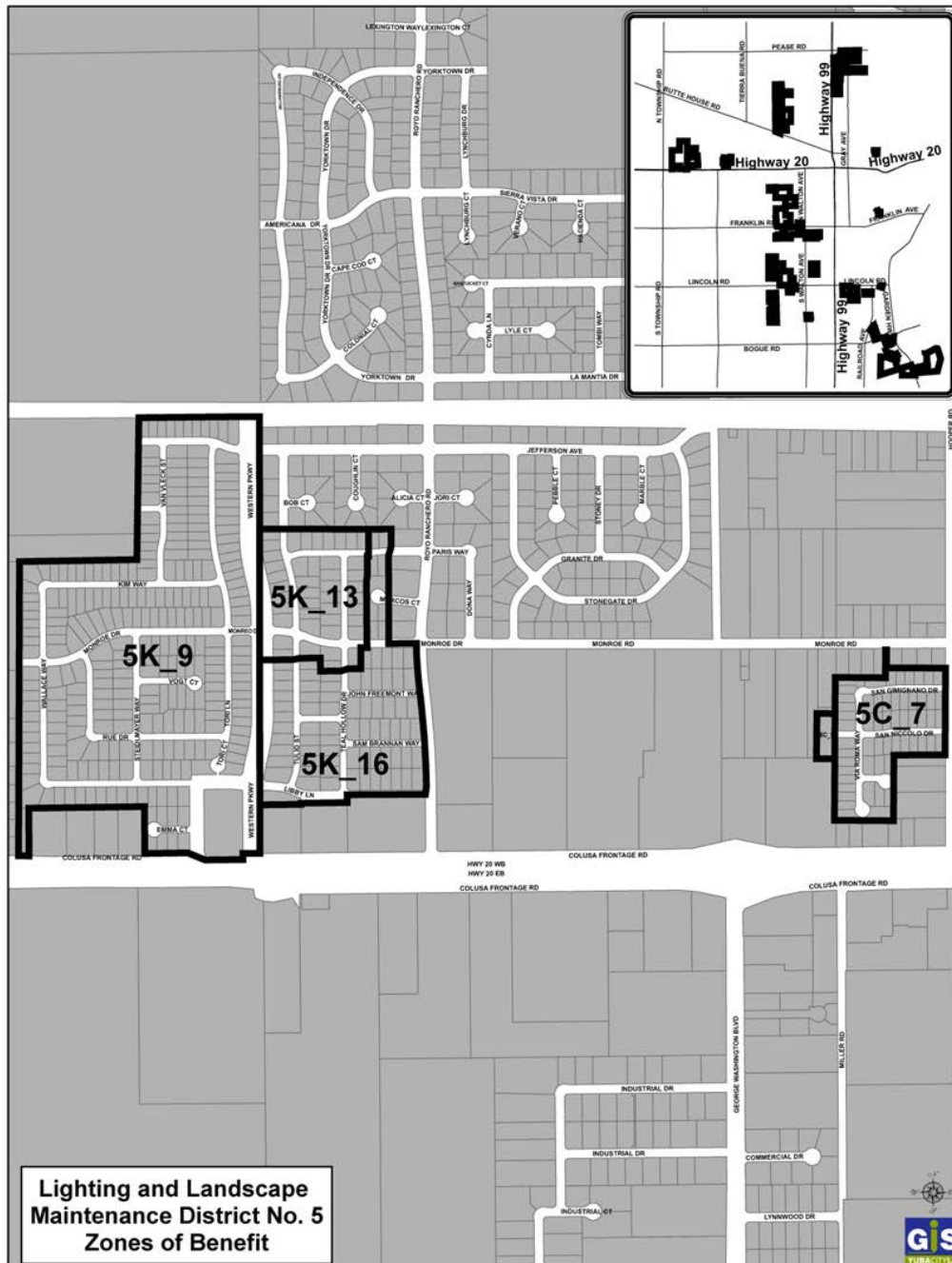

**Lighting and Landscape  
Maintenance District No. 5  
Zones of Benefit**



